

## STANDARD SPECIFICATIONS:

**DIAL:** 6" Diameter  
**CASE:** Stainless Steel  
**LENS:** Laminated Safety Glass  
**POINTER:** Micro Adjustable  
**BOURDON TUBE:** 316 Stainless Steel  
**SOCKET :** 316 Stainless Steel  
**MOVEMENT:** SS Heavy Duty  
**ACCURACY:** 1 % Full Scale

## STANDARD FEATURES

- \*Hermetically Sealed / Weather Proof
- \*Welded Case and Connection
- \*Liquid Fillable / No Kit Required

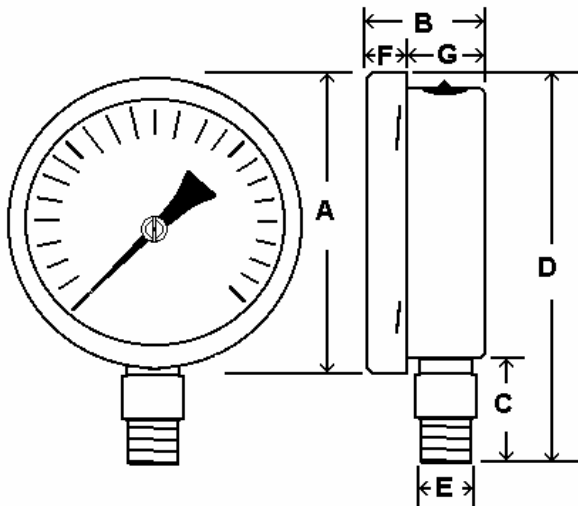

	A	B	C	D	E	F	G	Conn.
<b>INCH</b>	6.75"	2.00"	1.50"	8.41"	.54"	.73"	1.27"	1/4" or
<b>MM</b>	172	50	38	214	14	18	32	1/2"NPT

RANGE	FIGURES	MINOR
30"-0 hg vac	5"	0.2"
30"-0-15	10" & 5 psi	1" & 0.5 psi
30"-0-30	10" & 5 psi	1" & 0.5 psi
30"-0-60	10" & 10 psi	2" & 1 psi
30"-0-100	10" & 20 psi	2" & 1 psi
30"-0-150	10" & 30 psi	5" & 2 psi
30"-0-200	10" & 50 psi	5" & 2 psi
30"-0-300	10" & 50 psi	10" & 5 psi
30"-0-600	10" & 100 psi	10" & 10 psi
0-15 psi	3 psi	0.2 psi
0-30 psi	5 psi	0.2 psi
0-60 psi	5 psi	0.5 psi
0-100 psi	10 psi	1 psi
0-160 psi	20 psi	1 psi
0-200 psi	20 psi	2 psi
0-300 psi	50 psi	2 psi
0-400 psi	50 psi	2 psi
0-600 psi	50 psi	5 psi
0-800 psi	100 psi	5 psi
0-1000 psi	100 psi	10 psi
0-1500 psi	250 psi	10 psi
0-2000 psi	200 psi	20 psi
0-3000 psi	500 psi	20 psi
0-5000 psi	1,000 psi	50 psi
0-10,000 psi	1,000 psi	100 psi
0-15,000 psi	2,500 psi	100 psi
0-20,000 psi	2,000 psi	200 psi