

# PRECISION INSTRUMENT COMPANY

## PLASTIC CASE 'SEP' SERIES GAUGES

THESE GAUGES ARE DESIGNED FOR APPLICATIONS WHERE PLASTIC CASES AND BRASS INTERNALS ARE SUITABLE FOR USE. IT'S ABS CASE AND POLYCARBONATE LENS OFFERS GREAT APPEARANCE AND RESISTANCE TO WEATHER AND CORROSION ATTACK. TYPICAL APPLICATIONS INCLUDE WATER, AIR, OIL AND STEAM.

### SPECIFICATIONS:

DIAL SIZE: 2"

CONNECTION: 1/4"NPT

### DESCRIPTION:

BLACK ABS PLASTIC CASE

POLYCARBONATE LENS

PHOSPHOR BRONZE TUBE

BRASS SOCKET

3-2-3 % ACCURACY



BOTTOM	BACK	RANGE
SEP-101D-204A	SEP-102D-204A	30" HG VAC
SEP-101D-204B	SEP-102D-204B	0/15 PSI
SEP-101D-204C	SEP-102D-204C	0/30 PSI
SEP-101D-204D	SEP-102D-204D	0/60 PSI
SEP-101D-204E	SEP-102D-204E	0/100 PSI
SEP-101D-204F	SEP-102D-204F	0/160 PSI
SEP-101D-204G	SEP-102D-204G	0/200 PSI
SEP-101D-204H	SEP-102D-204H	0/300 PSI

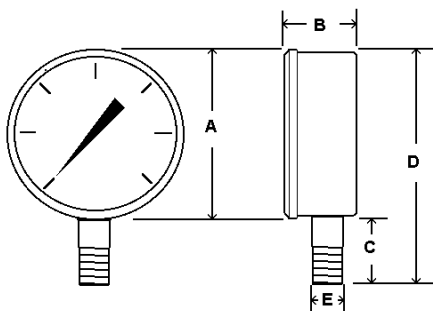

SEP-101D

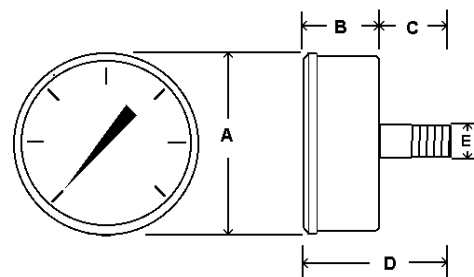

SEP-102D

DIM	DESCRIPTION	SEP-101D	SEP-102D
A	CASE OVERALL DIAMETER	2.28" / 58mm	2.28" / 58mm
B	DEPTH OF CASE	1.10" / 28mm	1.10" / 28mm
C	STEM LENGTH (INCLUDING THREADS)	.84" / 21mm	.84" / 21mm
D	OVERALL HEIGHT(PUMP) / DEPTH(PUMPCB)	2.98" / 76mm	1.94" / 49mm
E	WRENCH FLATS	.55" / 14mm	.55" / 14mm