

SEC-200 SERIES LIQUID FILLED

SPECIFICATIONS:

Stainless steel case and bezel
Brass internals and connection
Liquid filled (dry available)

Accuracy: 1 1/2" & 2" dial = 2 %
2 1/2" & 3 1/2" dial = 3-2-3 %
4" & 6" dial = 1 %

AVAILABLE DIAL SIZES:

1 1/2", 2", 2 1/2", 3 1/2", 4" and 6"

AVAILABLE CONNECTION SIZES:

1/8"MNPT on 1 1/2" and 2"
1/4"MNPT on 2" to 6"
1/2"MNPT on 4" and 6"

SEC-201L

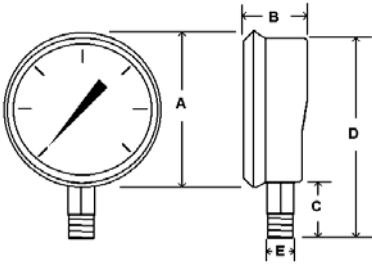

	1 1/2"	2"	2 1/2"	4"	6"
A	1.88"/48mm	2.24"/57mm	2.80"/71mm	4.32"/110mm	6.54"/166mm
B	1.06"/27mm	1.27"/32mm	1.28"/33mm	1.63"/42mm	1.70"/43mm
C	.89"/23mm	.71"/23mm	1.07"/27mm	1.25"/32mm	1.68"/43mm
D	2.77"/58mm	2.80"/71mm	3.55"/90mm	5.57"/141mm	8.22"/210mm
E	1/8npt	1/8 or 1/4npt	1/4mnpt	1/4 or 1/2npt	

SEC-202L

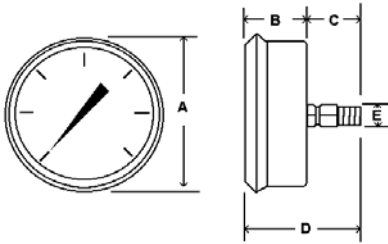

	1 1/2"	2"	2 1/2"	3 1/2" *	4"	6"
A	1.88"/48mm	2.23"/57mm	2.80"/71mm	3.82"/97mm	4.32"/110mm	6.54"/166mm
B	1.06"/27mm	1.09"/28mm	1.28"/33mm	1.16"/29mm	1.63"/42mm	1.70"/43mm
C	.89"/23mm	.71"/23mm	1.18"/30mm	1.06"/27mm	1.14"/29mm	1.68"/43mm
D	1.95"/50mm	1.99"/51mm	2.46"/63mm	2.22"/56mm	2.77"/71mm	3.38"/86mm
E	1/8npt	1/8 or 1/4npt	1/4mnpt	1/4mnpt		

* 3 1/2" Dial Size = Lower Back Mount Connection

SEC-203L

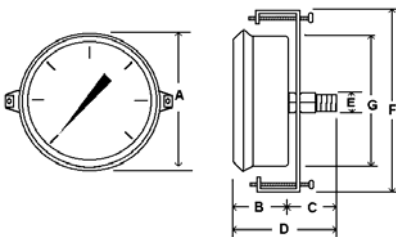

	1 1/2"	2"	2 1/2"	3 1/2" *	4"
A	1.88"/48mm	2.23"/57mm	2.80"/71mm	3.82"/97mm	4.32"/110mm
B	1.06"/27mm	1.09"/28mm	1.28"/33mm	1.16"/29mm	1.63"/42mm
C	.89"/23mm	.71"/23mm	1.19"/30mm	1.06"/27mm	1.14"/29mm
D	1.95"/50mm	1.99"/51mm	2.46"/63mm	2.22"/56mm	2.77"/71mm
E	1/8npt	1/8 or 1/4npt	1/4mnpt	1/4mnpt	1/4mnpt
F	2.63"/67mm	3.00"/76mm	3.49"/89mm	3.77"/96mm	5.30"/135mm
G	1.63"/42mm	2.00"/51mm	2.50"/64mm	3.49"/88mm	3.87"/98mm

* 3 1/2" Dial Size = Lower Back Mount Connection

SEC-204L

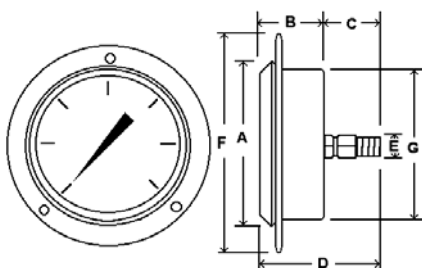

	1 1/2"	2"	2 1/2"	3 1/2" *	4"	6"
A	1.88"/48mm	2.23"/57mm	2.80"/71mm	3.82"/97mm	4.32"/110mm	6.54"/166mm
B	1.06"/27mm	1.09"/28mm	1.28"/33mm	1.16"/29mm	1.63"/42mm	1.70"/43mm
C	.89"/23mm	.71"/23mm	1.18"/30mm	1.06"/27mm	1.14"/29mm	1.68"/43mm
D	1.95"/50mm	1.99"/51mm	2.46"/63mm	2.22"/56mm	2.77"/71mm	3.38"/86mm
E	1/8npt	1/8 or 1/4npt	1/4mnpt	1/4mnpt		
F	2.46"/63mm	2.81"/72mm	3.48"/88mm	5.19"/132mm	5.20"/132mm	7.78"/198mm
G	1.63"/42mm	2.00"/51mm	2.50"/64mm	3.49"/88mm	3.87"/98mm	6.02"/153mm

* 3 1/2" Dial Size = Lower Back Mount Connection